

Friday, August 14, 2009

1420 Alhambra Dr, Lebanon, TN 37087-8301  
Wilson County, TN parcel# 058 015.22

## Property Report

Location	
Property Address	1420 Alhambra Dr Lebanon, TN 37087-8301
Subdivision	
County	Wilson County, TN

Property Summary	
Property Type	Commercial
Land Use	Household Unit
Improvement Type	Apartmnts Over 4Units
Total Square Feet	13230 sf

General Parcel Information	
Parcel/Tax ID	058 015.22
Special Int	000
Alternate Parcel ID	
Land Map	058
District/Ward	03
Census Tract/Block	305.00/3

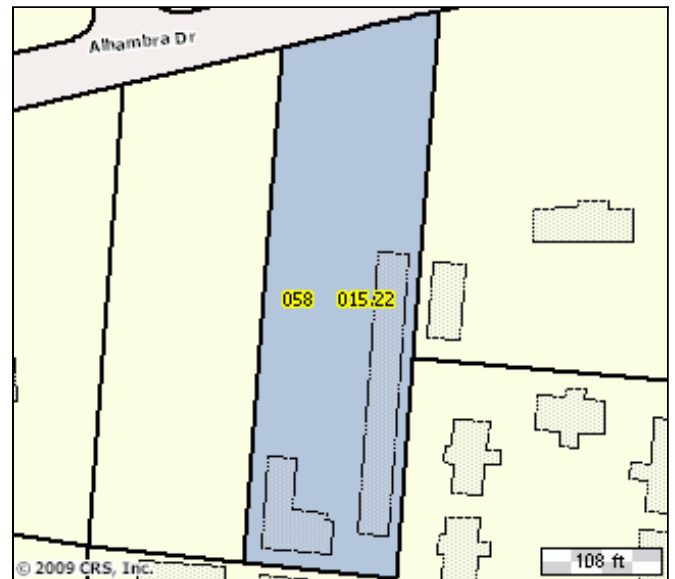

Tax Assessment					
Appraisals	Amount	Taxes	Amount	Jurisdiction	Rate
Tax Year	2008	City Taxes	\$931.57	Lebanon	0.335
Appraised Land	\$92,000	County Taxes	\$6,765.69	Wilson	2.433
Appraised Improvements	\$603,200	SSD Taxes	\$1,084.51	Lebanon Ssd	0.390
Total Tax Appraisal	<b>\$695,200</b>	Total Taxes	<b>\$8,781.77</b>		
Total Assessment	<b>\$278,080</b>	Exempt Amount			
		Exempt Reason			

## Property Characteristics: Building

Building #	Type	Condition	Size	Year Built	Effective Year	BRs	Baths	Rooms	Stories	Units
1	Apartmnts Over 4Units	Sound	13230	1989	1989				2	20

Building Square Feet (Living Space)		Building Square Feet (Other)	
First Story (Base)	6615	Other	
Upper Stories	6615	Other	
Total Area	13230	Other	
		Other	
		Other	

Construction			
Quality	Average	Roof Framing	Gable And Hip
Shape	Rectangular Design	Roof Cover Deck	Composition Shingle
Partitions		Cabinet Millwork	Average
Common Wall	None	Floor Finish	Carpet Combination
Foundation	Continuous Footing	Interior Finish	Drywall
Floor System	Wood W/ Sub Floor	Air Conditioning	
Exterior Wall	Brick	Heat Type	Radiant Heat

<b>Structural Framing</b>	None	<b>Bathroom Tile</b>	None
<b>Fireplace</b>		<b>Plumbing Fixtures</b>	60
<b>Other</b>			
<b>Occupancy</b>	Occupied	<b>Building Data Source</b>	Inspection

**Property Characteristics: Extra Features**

Feature	Size or Description	Year Built	Condition
T Court	50X100	1989	Average
Asph Pav			Satisfact
Pool	13X28	1990	Average
Wd Deck	6X10	1989	Average

**Property Characteristics: Lot**

<b>Land Use</b>	Household Unit
<b>Lot Dimensions</b>	
<b>Acreage</b>	1.55
<b>Block/Lot</b>	/2
<b>Latitude/Longitude</b>	36.233880°/-86.324448°

**Property Characteristics: Utilities/Area**

<b>Gas Source</b>	None	<b>Road Type</b>	Paved
<b>Electric Source</b>	Public	<b>Topography</b>	Level
<b>Water Source</b>	Public	<b>District Trend</b>	Static
<b>Sewer Source</b>	Individual	<b>Special School District 1</b>	405
<b>Zoning Code</b>		<b>Special School District 2</b>	0
<b>Owner Type</b>	Private		

**Legal Description**

<b>Subdivision</b>		<b>Plat Book/Page</b>	18 /499
<b>Block/Lot</b>	/2	<b>Description</b>	Alhambra Heights Apts
<b>District/Ward</b>	03		